

Square Nuts

Low Carbon Steel

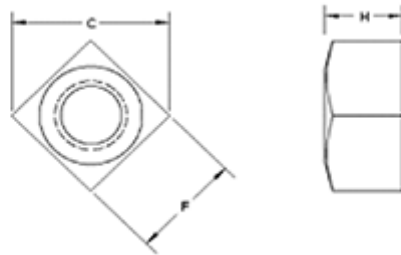

Plain = NQ020----

Zinc = NQ020----Z1

Diameter	F	T	Weight Per C
	Across Flats	Thick	
6-32	5/16	7/64	.75
8-32	11/32	1/8	1.1
10-24	3/8	1/8	1.52
10-32	3/8	1/8	2.11
1/4	7/16	7/32	3.83
5/16	9/16	17/64	
3/8	5/8	21/64	7.11
7/16	3/4	3/8	10.6
1/2	13/16	7/16	17.1
5/8	1	35/64	25.3
3/4	1 1/8	21/32	37.1
7/8	15/16	49/64	52.5
1	1 1/2	7/8	75.1
1 1/8	1 11/16	1	94.8
1 1/4	1 7/8	1 3/32	114
1 3/8	2 1/16	1 13/64	134
1 1/2	2 1/4	1 5/16	200